

Diesel Inverter Marine Generator

SLEEPER H-MG8i

Thanks to the PMG inverter technology, the Sleeper generator H-MG8i is possible to be made into the smallest, quietest and most powerful of its kind. It delivers the ideal power quality for all on-board appliances such as air-conditioning system, washing machine, cooking devices, battery charging and other AC powered devices. The sleeper generators are 100% water-cooled and equipped with the highly regarded sound insulation. They are specially designed to be light and compact, up to 30% weight and space savings.



Product features

- Reliable Kubota 2 cylinder water-cooled diesel engine ensure product reliability
- High efficient water-cooled permanent magnet alternator technology
- Extremely compact size and light weight for installation
- Extremely silent by aluminum composite material cabinet
- Virtually vibration free
- Outstanding voltage stability and pure sines wave are ideal for sensitive electronics
- Inverter technology saves fuel about 30% and environmentally friendly
- Local and remote digital display control panel with highly intelligent multi-function protection
- Parallel technology enables more power and cost saving



Light | Small | Compact | Quiet

www.sleeper-generator.com

H-MG8i

| | | | |
|----------|---------------|----------|---------------|
| 80823050 | 230 V / 50 Hz | 80823060 | 230 V / 60 Hz |
| 80812050 | 120 V / 50 Hz | 80812060 | 120 V / 60 Hz |

MAIN SPECIFICATIONS

| | |
|---------------------------|--|
| Nominal voltage(V) | 230 / 120 |
| Frequency(Hz) | 50 / 60 |
| Number of phases | 1 |
| Intermittent power | 6.4kW / 8kVA |
| Continuous power | 6kW / 7.5kVA |
| Noise(dBa/7m) | 51 |
| Rpm range | 2200 - 3000, adjustable |
| Cooling system | Heat exchanger |
| Harmonic distortion | ≤3% |
| Frequency stability | ±0.1% |
| Alternator technology | Water-cooled, Brushless, Permanent Magnet |
| Generator control | PMG Inverter |
| Inverter (with DDC local) | PMGi 8 |
| Control Panel | Digital Display Control (DDC local + DDC remote) |

DIESEL ENGINE SPECIFICATIONS

| | |
|--|--------------------|
| Engine model | Kubota Z482 |
| Engine power output | 8.3kW / 3000rpm |
| Cylinder | 2 |
| Displacement(cc) | 479 |
| Bore x stroke (mm) | 67 × 68 |
| Fuel consumption | 1.5 - 2.5 |
| Start battery capacity | 12VDC / 80Ah |
| Starter battery charge method/ current | Alternator 12V/14A |
| Lubricant | At least CF |
| Oil capacity(L) | 2.5 |

DIMENSIONS & WEIGHT

| | |
|----------------------------|--------------------|
| Cabinet dimensions (LxWxH) | 478 x 445 x 558 mm |
| Cabinet weight | 111 kg |
| Water inlet hose | Ø19mm |
| Exhaust hose | Ø40mm |
| Fuel Hose | Ø 8mm |
| Siphon breaker | Ø19mm |

Dimensions

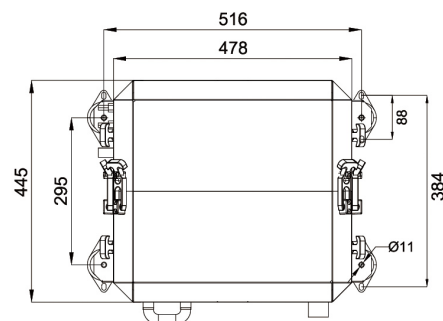
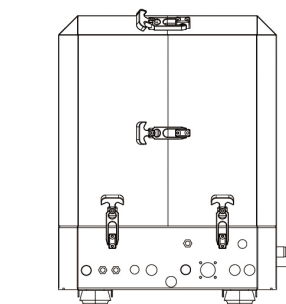
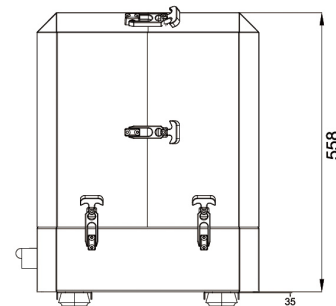
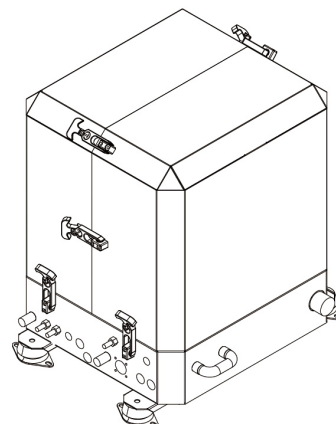

STANDARD ACCESSORIES

- | | |
|---------------------------------------|--------------------------------------|
| 1.Remote control panel with 15m cable | 2. PMG Inverter |
| 3. Waterlock with 2m exhaust hose | 4. Expansion tank with 2m water hose |
| 5.Electric fuel pump | 6. Fuel-water separator |
| 7.Syphon breaker | 8. Seawater filter |
| 9.Non-return valve | 10.Clamps and screws |
| 11.User's manual | |

Generator Control Panel GEC4500

The GEC4500 series controller provides remote start/stop and advanced control, system monitoring, and system diagnostics for optimum performance and compatibility.

General Description:

- Overall Dimension: 152 x 100 x 84.7mm
- Panel Cutout: 116 x 90mm
- Weight: 320g
- Voltage supply: 8V - 35V
- Operating temperature: -25+70 °C
- RS485, CAN bus output with SAEJ1939 protocol

Digital Display Information:

- Voltage (V)
- Frequency (Hz)
- Current (A)
- Power (kW)
- Oil Pressure(bar)
- Coolant Temperature (°C)
- Battery Voltage (V)
- RPM
- Fuel level
- Running hours
- History log

Alarm:

- High temperature
- Over speed
- Over load
- Over current
- Short circuit
- Low oil pressure
- Over/Under voltage
- Over/Under frequency
- Emergency stop

Warnings

- Over/Under battery voltage
- Maintenance request



Generator Control Panel

Installation system

This diagram showcases a complete view of necessary installation facilities for a single Sleeper generator. We highly recommend our respectful users to exclusively employ the facilities originally offered by us.

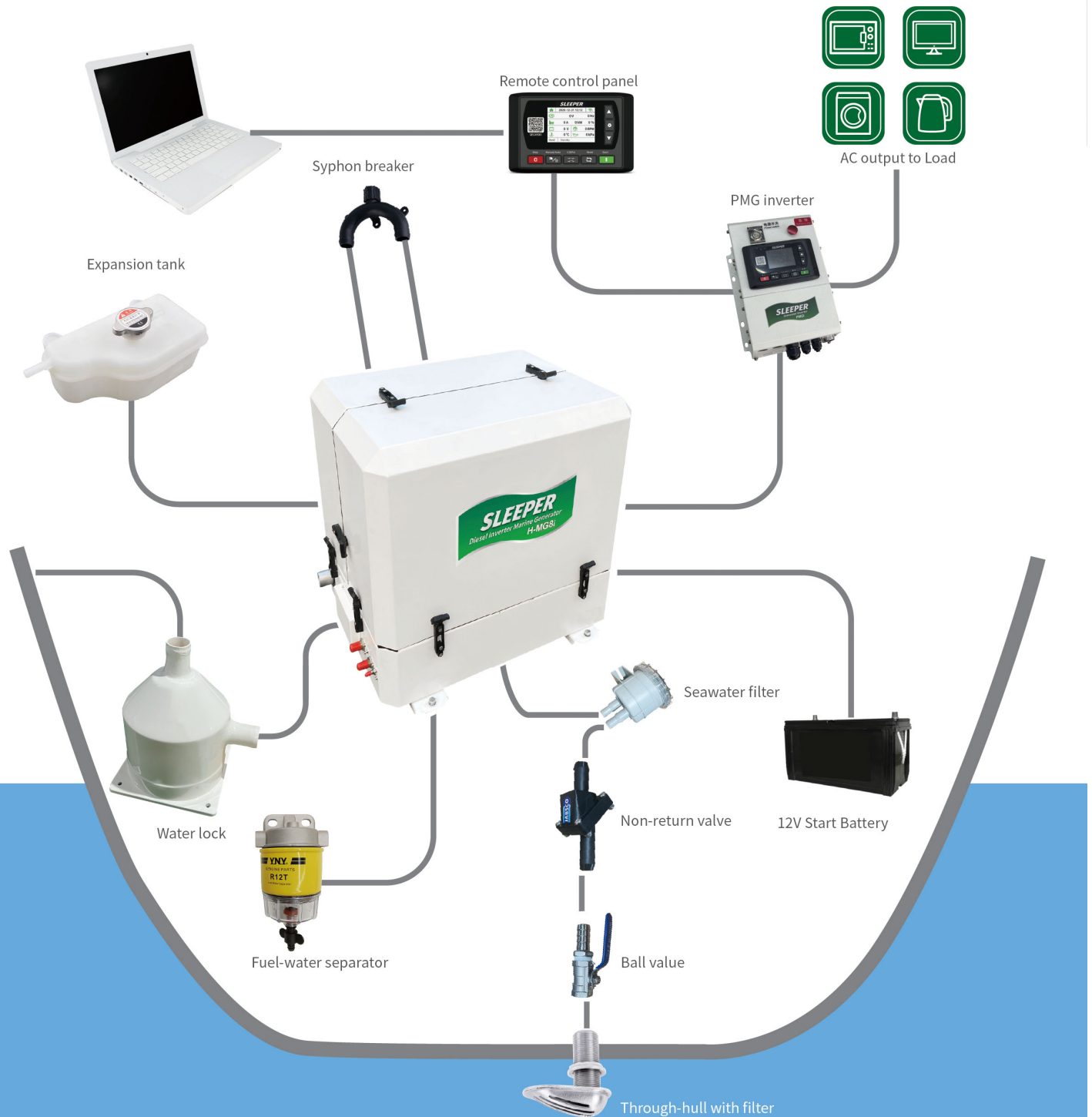

Cixi Handsometech Generator Co., Ltd
No.5 Hengpeng Road, Henghe Town, Cixi, Zhejiang Province, China, 315318
Tel/Fax : +86-574-63265576
www.sleeper-generator.com
sales@sleeper-generator.com

Authorized dealer: